

PLANS OF THE CHOIR in C12th & C13th

Closed for Business by Harold Brooke has as appendix 3, G E Street's report to the Bishop of Lincoln of June 1876.

In this he refers to two plans attached to the report but which are not included in the appendix. They are shown overleaf – copied from a file in Nottinghamshire Archives.

N°1 *Plan showing position of Altar In 12th Century*

SOUTHWELL MINSTER N°11 *Plan showing the arrangement of Altars, Screens & Choir after Choir had been rebuilt in the 13th Century.*

SOUTHWELL MINSTER N^o. II

Plan showing the arrangement of Altars, Screens & Choir after their had been rebuilt in the 15th Cent.

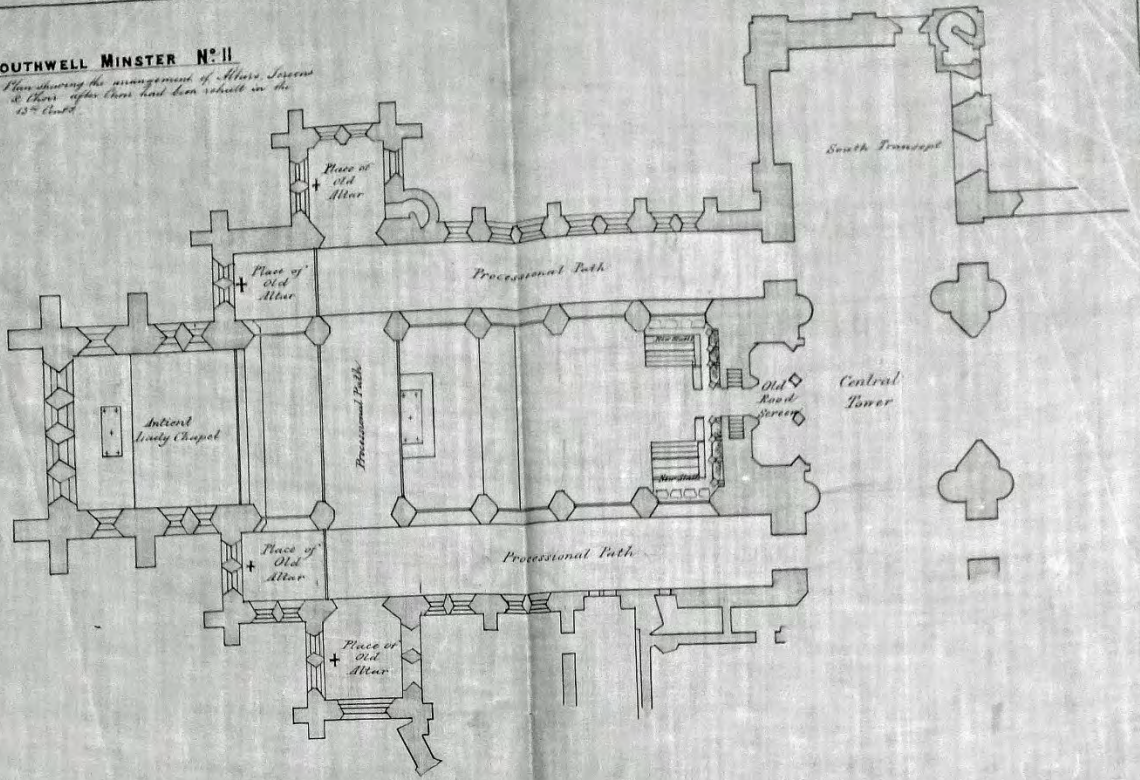

N^o. I *Plan showing position of Altar in the 12th Century.*

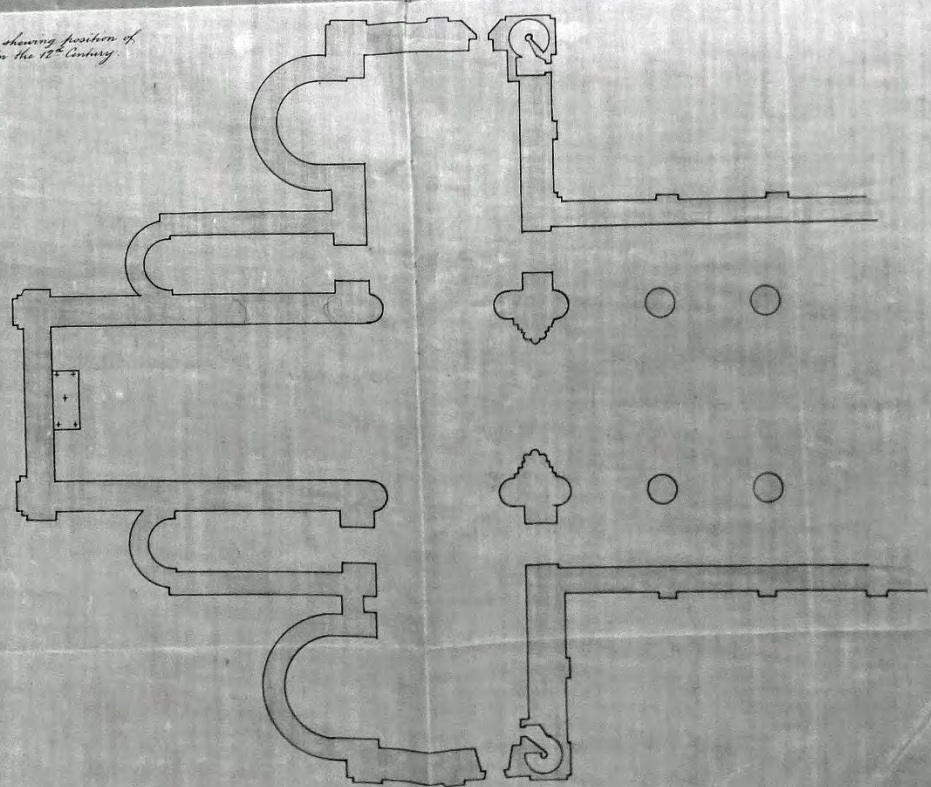

Scale of Feet

